

B - I

B - 1

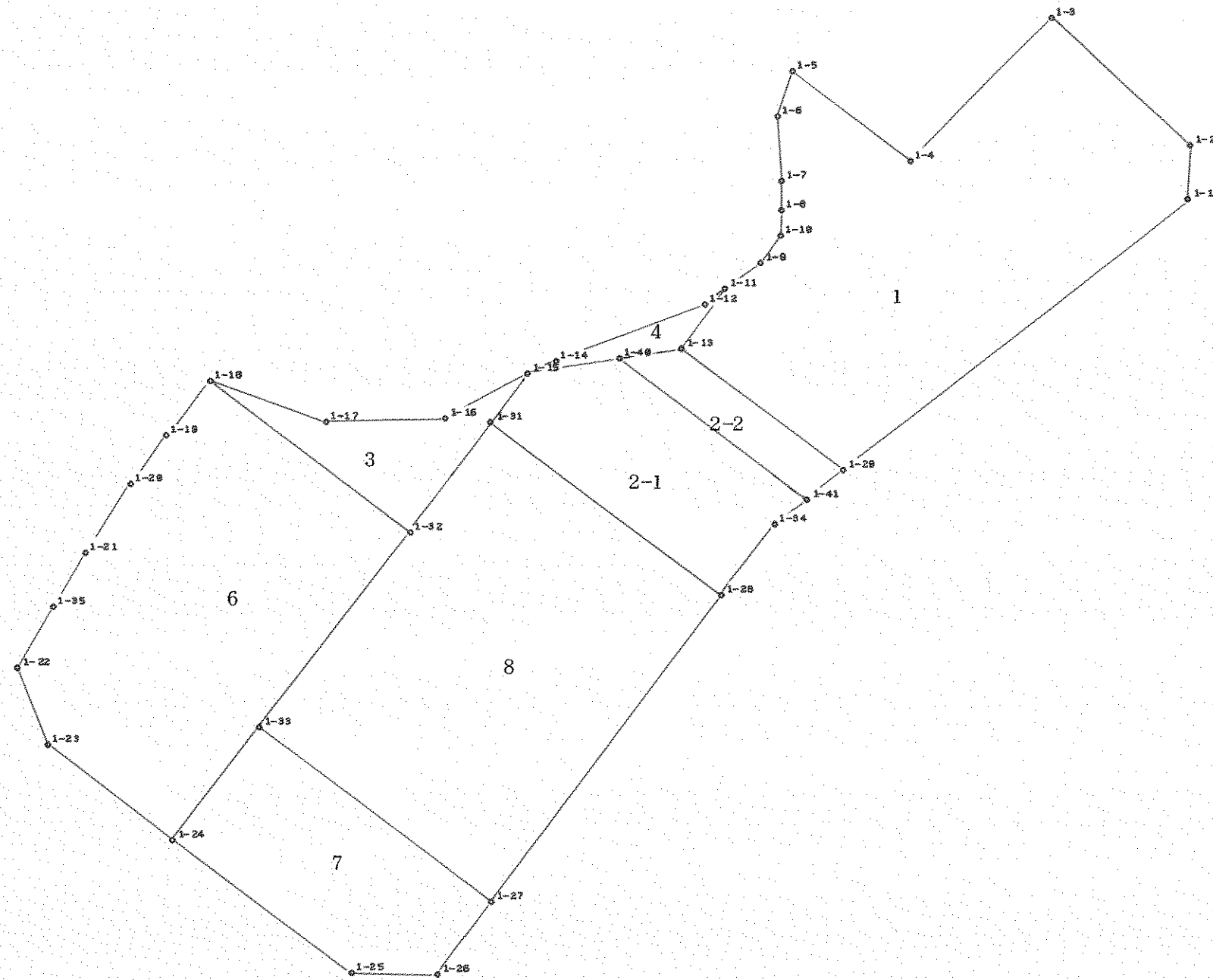

* * 座 標 L I S T * * (現 場 N O . 1)

測点名	X 座 標	Y 座 標
1-1	-60946.504	-87923.175
1-2	-60942.052	-87924.574
1-3	-60935.763	-87939.680
1-4	-60951.511	-87946.847
1-5	-60947.806	-87959.080
1-6	-60951.858	-87959.009
1-7	-60956.996	-87956.697
1-8	-60959.391	-87955.852
1-9	-60964.264	-87955.962
1-10	-60961.402	-87955.224
1-11	-60967.360	-87958.115
1-12	-60969.230	-87959.318
1-13	-60973.540	-87959.859
1-14	-60978.231	-87969.655
1-15	-60980.038	-87971.568
1-16	-60986.221	-87976.965
1-17	-60990.009	-87986.568
1-18	-60990.135	-87997.097
1-19	-60995.805	-87999.078
1-20	-61000.787	-88000.522
1-21	-61007.806	-88002.154
1-22	-61019.058	-88004.250
1-23	-61024.424	-87999.643
1-24	-61028.393	-87986.596
1-25	-61033.952	-87968.321
1-26	-61031.419	-87961.302
1-27	-61023.917	-87959.030
1-28	-60992.292	-87949.409
1-29	-60978.614	-87943.186
1-31	-60985.158	-87973.093
1-32	-60996.466	-87976.501
1-33	-61016.678	-87982.897
1-34	-60985.019	-87947.186
1-35	-61013.101	-88003.202
1-40	-60976.168	-87964.594
1-41	-60981.982	-87945.290

* * 面積計算 (座標法) * *

地番 器械点	視準点	内角	方向角	距離	[1] X(i)	[2] Y(i)	[3] X(i+1)-X(i-1)	[2]*[3]	
1-1	1-2	130-37-27	342-33-19	4.667	-60946.504	-87923.175	36.562	-3214647.124350	
1-2	1-3	130-02-52	292-36-11	16.363	-60942.052	-87924.574	10.741	-944397.849334	
1-3	1-4	91-52-03	204-28-14	17.302	-60935.763	-87939.680	-9.459	831821.433120	
1-4	1-5	262-22-46	286-51-00	12.782	-60951.511	-87946.847	-12.043	1059143.878421	
1-5	1-6	72-08-46	178-59-46	4.053	-60947.806	-87959.080	-0.347	30521.800760	
1-6	1-7	156-46-37	155-46-23	5.634	-60951.858	-87959.009	-9.190	808343.292710	
1-7	1-8	184-47-35	160-33-58	2.540	-60956.996	-87956.697	-7.533	662577.798501	
1-8	1-10	182-05-28	162-39-26	2.107	-60959.391	-87955.852	-4.406	387533.483912	
1-10	1-9	211-48-08	194-27-34	2.956	-60961.402	-87955.224	-4.873	428605.806552	
1-9	1-11	200-21-21	214-48-55	3.771	-60964.264	-87955.962	-5.958	524041.621596	
1-11	1-13	160-56-38	195-45-33	6.421	-60967.360	-87958.115	-9.276	815899.474740	
1-13	1-29	91-10-02	106-55-35	17.428	-60973.540	-87959.859	-11.254	989900.253186	
1-29	1-1	105-00-17	31-55-52	37.835	-60978.614	-87943.186	27.036	-2377631.976696	
								倍面積	1711.893118
								面積	855.946590
								(坪數)	(258.923)

* * 面積計算 (座標法) * *

地番 器械点	視準点	内角	方向角	距離	[1] X(i)	[2] Y(i)	[3] X(i+1)-X(i-1)	[2]*[3]	
1-40	1-15	134-12-31	240-58-18	7.976	-60976.168	-87964.594	1.944	-171003.170736	
1-15	1-31	135-36-52	196-35-10	5.342	-60980.038	-87971.568	-8.990	790864.396320	
1-31	1-28	90-10-37	106-45-47	24.735	-60985.158	-87973.093	-12.254	1078022.281622	
1-28	1-34	90-13-58	16-59-45	7.605	-60992.292	-87949.409	0.139	-12224.967851	
1-34	1-41	194-59-22	31-59-07	3.580	-60985.019	-87947.186	10.310	-906735.487660	
1-41	1-40	74-46-40	286-45-47	20.161	-60981.982	-87945.290	8.851	-778403.761790	
								倍面積	519.289905
								面積	259.6449525
								(坪數)	(78.542)

* * 面積計算 (座標法) * *

地番 器械点	視準点	内角	方向角	距離	[1] X(i)	[2] Y(i)	[3] X(i+1)-X(i-1)	[2]*[3]	
1-29	1-13	74-56-28	286-55-35	17.428	-60978.614	-87943.186	8.442	-742416.376212	
1-13	1-40	134-02-43	240-58-18	5.415	-60973.540	-87959.859	2.446	-215149.815114	
1-40	1-41	45-47-29	106-45-47	20.161	-60976.168	-87964.594	-8.442	742597.102548	
1-41	1-29	105-13-20	31-59-07	3.971	-60981.982	-87945.290	-2.446	215114.179340	
								倍面積	145.090562
								面積	72.5452810
								(坪數)	(21.944)

* * 面積計算 (座標法) * *

地番 器械点	視準点	内角	方向角	距離	[1] X(i)	[2] Y(i)	[3] X(i+1)-X(i-1)	[2]*[3]
1-15	1-16	24-31-52	221-07-02	8.208	-60980.038	-87971.568	-1.063	93513.776784
1-16	1-17	207-21-16	248-28-18	10.323	-60986.221	-87976.965	-9.971	877218.318015
1-17	1-18	200-50-42	269-19-00	10.530	-60990.009	-87986.568	-3.914	344379.427152
1-18	1-32	17-46-13	107-05-13	21.547	-60990.135	-87997.097	-6.457	568197.255329
1-32	1-31	89-41-05	16-46-18	11.810	-60996.466	-87976.501	4.977	-437859.045477
1-31	1-15	179-48-52	16-35-10	5.342	-60985.158	-87973.093	16.428	-1445221.971804
								倍面積
								面積
								(坪数)

* * 面積計算 (座標法) * *

地番 器械点	視準点	内角	方向角	距離	[1] X(i)	[2] Y(i)	[3] X(i+1)-X(i-1)	[2]*[3]
1-11	1-12	16-59-41	212-45-14	2.224	-60967.360	-87958.115	4.310	-379099.475650
1-12	1-14	196-11-54	228-57-08	13.707	-60969.230	-87959.318	-10.871	956205.745978
1-14	1-15	177-40-48	226-37-56	2.632	-60978.231	-87969.655	-10.808	950776.031240
1-15	1-40	14-20-22	60-58-18	7.976	-60980.038	-87971.568	2.063	-181485.344784
1-40	1-13	180-00-00	60-58-18	5.415	-60976.168	-87964.594	6.498	-571593.931812
1-13	1-11	134-47-15	15-45-33	6.421	-60973.540	-87959.859	8.808	-774750.438072
								倍面積
								面積
								(坪数)

* * 面積計算 (座標法) * *

地番 器械点	視準点	内角	方向角	距離	[1] X(i)	[2] Y(i)	[3] X(i+1)-X(i-1)	[2]*[3]
1-32	1-18	89-31-38	287-05-13	21.547	-60996.466	-87976.501	26.543	-2335160.266043
1-18	1-19	92-10-18	199-15-31	6.006	-60990.135	-87997.097	0.661	-58166.081117
1-19	1-20	176-54-19	196-09-50	5.187	-60995.805	-87999.078	-10.652	937366.178856
1-20	1-21	176-55-32	193-05-22	7.206	-61000.787	-88000.522	-12.001	1056094.264522
1-21	1-35	178-06-22	191-11-44	5.398	-61007.806	-88002.154	-12.314	1083658.524356
1-35	1-22	178-46-56	189-58-40	6.048	-61013.101	-88003.202	-11.252	990212.028904
1-22	1-23	129-22-28	139-21-08	7.072	-61019.058	-88004.250	-11.323	996472.122750
1-23	1-24	147-34-05	106-55-13	13.637	-61024.424	-87999.643	-9.335	821476.667405
1-24	1-33	90-36-11	17-31-24	12.285	-61028.393	-87986.596	7.746	-681544.172616
1-33	1-32	180-02-11	17-33-35	21.200	-61016.678	-87982.897	31.927	-2809029.952519
								倍面積
								面積
								(坪数)

* * 面積計算 (座標法) * *

地番 器械点	視準点	内角	方向角	距離	[1] X(i)	[2] Y(i)	[3] X(i+1)-X(i-1)	[2]*[3]
1-24	1-25	89-23-45	106-55-09	19.102	-61028.393	-87986.596	-17.274	1519880.459304
1-25	1-26	143-14-15	70-09-24	7.462	-61033.952	-87968.321	-3.026	266192.139346
1-26	1-27	126-41-33	16-50-57	7.838	-61031.419	-87961.302	10.035	-882691.665570
1-27	1-33	90-01-25	286-52-22	24.941	-61023.917	-87959.030	14.741	-1296604.061230
1-33	1-24	90-39-02	197-31-24	12.285	-61016.678	-87982.897	-4.476	393811.446972
							倍面積	588.318822
							面積	294.1594110
							(坪数)	(88.983)

* * 面積計算 (座標法) * *

地番 器械点	視準点	内角	方向角	距離	[1] X(i)	[2] Y(i)	[3] X(i+1)-X(i-1)	[2]*[3]
1-27	1-28	90-02-53	16-55-15	33.056	-61023.917	-87959.030	24.386	-2144968.905580
1-28	1-31	89-50-32	286-45-47	24.735	-60992.292	-87949.409	38.759	-3408831.143431
1-31	1-32	90-00-31	196-46-18	11.810	-60985.158	-87973.093	-4.174	367199.690182
1-32	1-33	180-47-17	197-33-35	21.200	-60996.466	-87976.501	-31.520	2773019.311520
1-33	1-27	89-18-47	106-52-22	24.941	-61016.678	-87982.897	-27.451	2415218.505547
							倍面積	1637.458238
							面積	818.7291190
							(坪数)	(247.665)

B - 2

画地面積成果表

街区番号	画地番号	面 積 <small>m²</small>	摘 要	街区番号	画地番号	面 積 <small>m²</small>	摘 要
B - 2	1	670.69					
	2	907.71					
	3	523.45					
	4	671.36					
	5	661.36					
	6	651.14					
計		4085.71					

B - 2

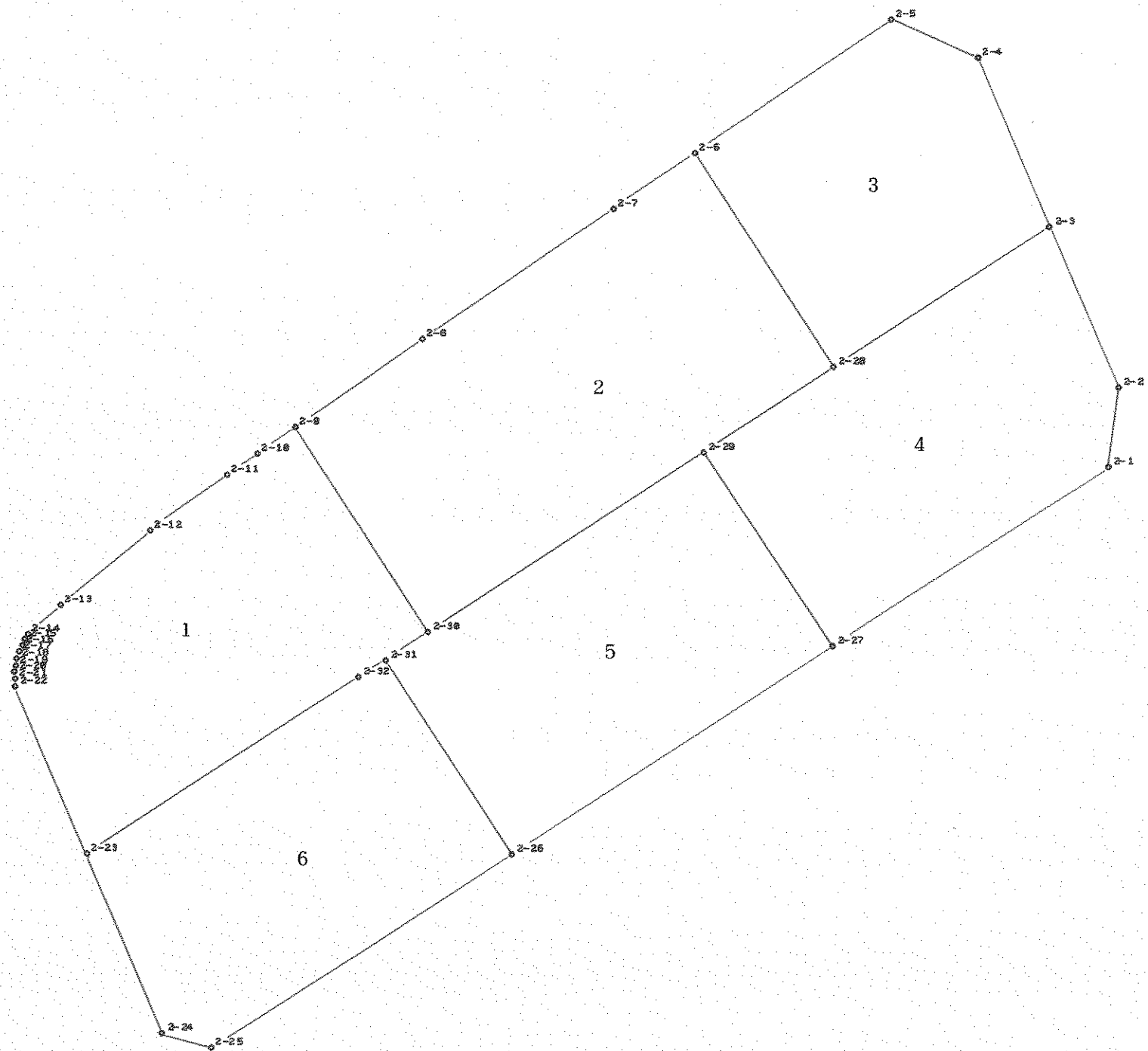

SCALE 1/500.000 ANGLE 50.000

* * 座 標 L I S T * * (現 場 N O . 1)

測点名	X 座 標	Y 座 標
2-1	-61048.062	-87964.949
2-2	-61043.004	-87969.561
2-3	-61038.603	-87984.007
2-4	-61033.943	-87999.247
2-5	-61037.573	-88006.579
2-6	-61058.067	-88008.644
2-7	-61066.528	-88009.514
2-8	-61086.547	-88011.557
2-9	-61099.829	-88012.780
2-10	-61103.777	-88013.149
2-11	-61107.050	-88013.378
2-12	-61115.237	-88013.956
2-13	-61125.325	-88014.076
2-14	-61129.127	-88013.957
2-15	-61129.548	-88013.818
2-16	-61130.113	-88013.582
2-17	-61130.643	-88013.290
2-18	-61131.153	-88012.952
2-19	-61131.637	-88012.577
2-20	-61132.077	-88012.157
2-21	-61132.473	-88011.689
2-22	-61132.820	-88011.194
2-23	-61137.471	-87996.141
2-24	-61142.492	-87979.908
2-25	-61140.104	-87976.241
2-26	-61109.208	-87972.476
2-27	-61076.352	-87968.447
2-28	-61060.753	-87986.730
2-29	-61074.131	-87988.377
2-30	-61102.406	-87991.839
2-31	-61106.760	-87992.371
2-32	-61109.588	-87992.723

* * 面積計算 (座標法) * *

地番 器械点	2-1 視準点	内角	方向角	距離	[1] X(i)	[2] Y(i)	[3] X(i+1)-X(i-1)	[2]*[3]	
2-9	2-10	88-19-27	185-20-23	3.965	-61099.829	-88012.780	-1.371	120665.521380	
2-10	2-11	178-39-45	184-00-08	3.281	-61103.777	-88013.149	-7.221	635542.948929	
2-11	2-12	180-02-10	184-02-18	8.207	-61107.050	-88013.378	-11.460	1008633.311880	
2-12	2-13	176-38-35	180-40-53	10.089	-61115.237	-88013.956	-18.275	1608455.045900	
2-13	2-14	177-31-33	178-12-26	3.804	-61125.325	-88014.076	-13.890	1222515.515640	
2-14	2-15	163-31-17	161-43-43	0.443	-61129.127	-88013.957	-4.223	371682.940411	
2-15	2-16	175-36-04	157-19-47	0.612	-61129.548	-88013.818	-0.986	86781.624548	
2-16	2-17	173-49-05	151-08-52	0.605	-61130.113	-88013.582	-1.095	96374.872290	
2-17	2-18	175-19-05	146-27-57	0.612	-61130.643	-88013.290	-1.040	91533.821600	
2-18	2-19	175-45-57	142-13-54	0.612	-61131.153	-88012.952	-0.994	87484.874288	
2-19	2-20	174-06-02	136-19-56	0.608	-61131.637	-88012.577	-0.924	81323.621148	
2-20	2-21	173-54-15	130-14-11	0.613	-61132.077	-88012.157	-0.836	73578.163252	
2-21	2-22	174-47-40	125-01-51	0.605	-61132.473	-88011.689	-0.743	65392.684927	
2-22	2-23	162-08-20	107-10-11	15.755	-61132.820	-88011.194	-4.998	439879.947612	
2-23	2-32	79-49-08	6-59-19	28.092	-61137.471	-87996.141	23.232	-2044326.347712	
2-32	2-31	180-06-23	7-05-42	2.850	-61109.588	-87992.723	30.711	-2702344.516053	
2-31	2-30	179-52-16	6-57-58	4.386	-61106.760	-87992.371	7.182	-631961.208522	
2-30	2-9	90-02-58	277-00-56	21.099	-61102.406	-87991.839	6.931	-609871.436109	
								倍面積 面積 (坪数)	1341.385409 670.6927045 (202.884)

* * 面積計算 (座標法) * *

地番 器械点	2-2 視準点	内角	方向角	距離	[1] X(i)	[2] Y(i)	[3] X(i+1)-X(i-1)	[2]*[3]	
2-6	2-7	88-52-59	185-52-15	8.506	-61058.067	-88008.644	-5.775	508249.919100	
2-7	2-8	179-57-22	185-49-37	20.123	-61066.528	-88009.514	-28.480	2506510.958720	
2-8	2-9	179-26-02	185-15-39	13.338	-61086.547	-88011.557	-33.301	2930872.859657	
2-9	2-30	91-45-17	97-00-56	21.099	-61099.829	-88012.780	-15.859	1395794.678020	
2-30	2-29	89-57-54	6-58-50	28.486	-61102.406	-87991.839	25.698	-2261214.278622	
2-29	2-28	180-02-17	7-01-07	13.479	-61074.131	-87988.377	41.653	-3664979.867181	
2-28	2-6	89-58-09	276-59-16	22.078	-61060.753	-87986.730	16.064	-1413418.830720	
								倍面積 面積 (坪数)	1815.438974 907.7194870 (274.585)

* * 面積計算 (座標法) * *

地番 器械点	2-3 視準点	内角	方向角	距離	[1] X(i)	[2] Y(i)	[3] X(i+1)-X(i-1)	[2]*[3]	
2-3	2-4	99-59-38	287-00-08	15.937	-61038.603	-87984.007	26.810	-2358851.227670	
2-4	2-5	136-39-30	243-39-38	8.181	-61033.943	-87999.247	1.030	-90639.224410	
2-5	2-6	122-05-36	185-45-14	20.598	-61037.573	-88006.579	-24.124	2123070.711796	
2-6	2-28	91-14-02	96-59-16	22.078	-61058.067	-88008.644	-23.180	2040040.367920	
2-28	2-3	90-01-14	7-00-30	22.317	-61060.753	-87986.730	19.464	-1712573.712720	
								倍面積 面積 (坪数)	1046.914916 523.4574580 (158.345)

* * 面積計算 (座標法) * *

地番 器械点	2-4 視準点	内角	方向角	距離	[1] X(i)	[2] Y(i)	[3] X(i+1)-X(i-1)	[2]*[3]
2-1	2-2	130-35-32	317-38-27	6.845	-61048.062	-87964.949	33.348	-2933455.119252
2-2	2-3	149-18-09	286-56-36	15.102	-61043.004	-87969.561	9.459	-832104.077499
2-3	2-28	80-03-54	187-00-30	22.317	-61038.603	-87984.007	-17.749	1561628.140243
2-28	2-29	180-00-37	187-01-07	13.479	-61060.753	-87986.730	-35.528	3125992.543440
2-29	2-27	89-20-25	96-21-32	20.053	-61074.131	-87988.377	-15.599	1372530.692823
2-27	2-1	90-41-23	7-02-55	28.505	-61076.352	-87968.447	26.069	-2293249.444843
							倍面積	1342.734912
							面積	671.3674560
							(坪数)	(203.088)

* * 面積計算 (座標法) * *

地番 器械点	2-5 視準点	内角	方向角	距離	[1] X(i)	[2] Y(i)	[3] X(i+1)-X(i-1)	[2]*[3]
2-26	2-27	89-58-35	6-59-28	33.102	-61109.208	-87972.476	30.408	-2675067.050208
2-27	2-29	89-22-04	276-21-32	20.053	-61076.352	-87968.447	35.077	-3085669.215419
2-29	2-30	90-37-18	186-58-50	28.486	-61074.131	-87988.377	-26.054	2292449.174358
2-30	2-31	179-59-08	186-57-58	4.386	-61102.406	-87991.839	-32.629	2871085.714731
2-31	2-26	90-02-55	97-00-53	20.045	-61106.760	-87992.371	-6.802	598524.107542
							倍面積	1322.731004
							面積	661.3655020
							(坪数)	(200.063)

* * 面積計算 (座標法) * *

地番 器械点	2-6 視準点	内角	方向角	距離	[1] X(i)	[2] Y(i)	[3] X(i+1)-X(i-1)	[2]*[3]
2-23	2-24	100-11-55	107-11-14	16.992	-61137.471	-87996.141	-32.904	2895425.023464
2-24	2-25	129-44-24	56-55-38	4.376	-61142.492	-87979.908	-2.633	231651.097764
2-25	2-26	130-01-14	6-56-52	31.125	-61140.104	-87976.241	33.284	-2928201.205444
2-26	2-31	90-04-01	277-00-53	20.045	-61109.208	-87972.476	33.344	-2933354.239744
2-31	2-32	90-04-49	187-05-42	2.850	-61106.760	-87992.371	-0.380	33437.100980
2-32	2-23	179-53-37	186-59-19	28.092	-61109.588	-87992.723	-30.711	2702344.516053
							倍面積	1302.293073
							面積	651.1465365
							(坪数)	(196.971)

B - 3

B - 3

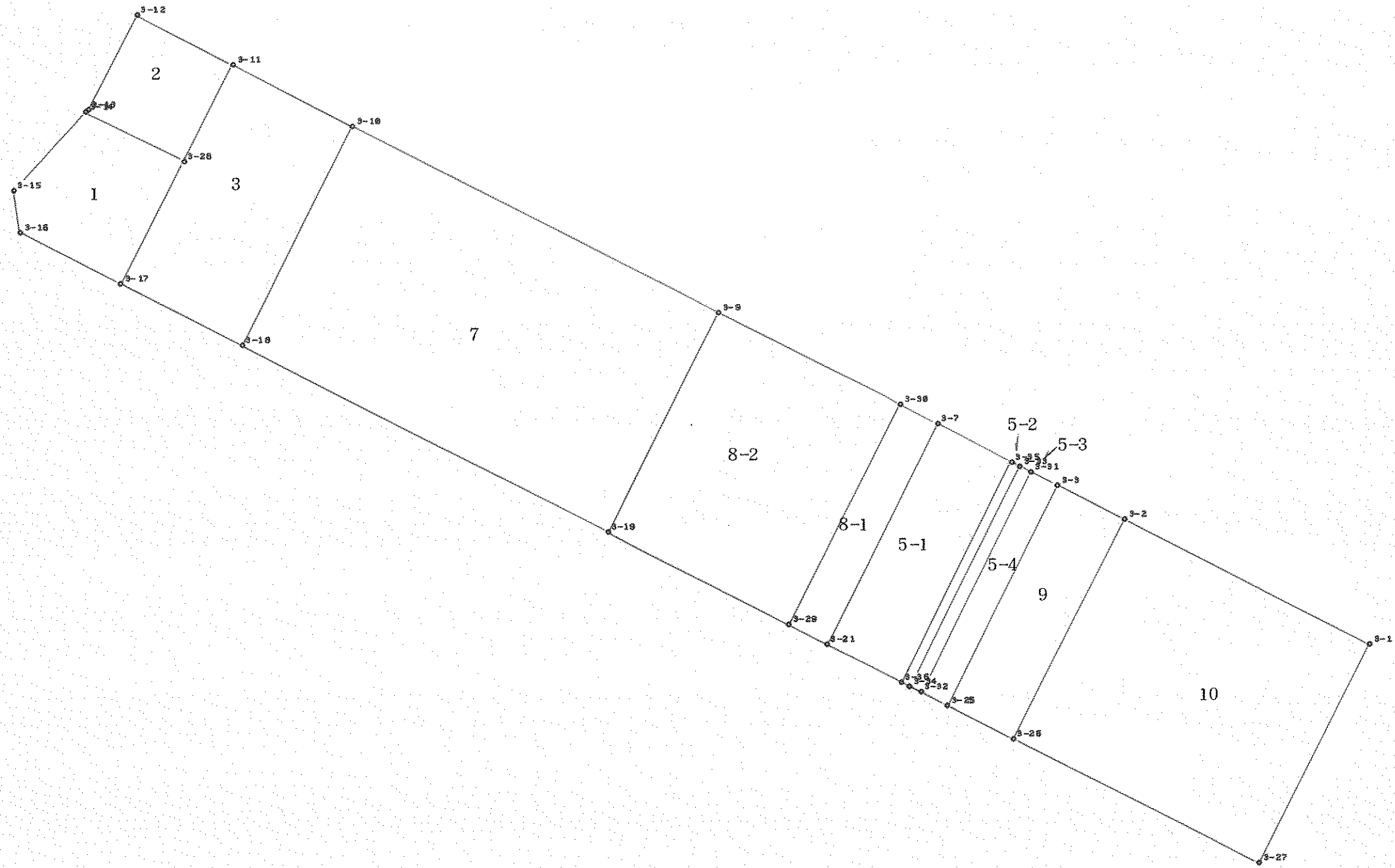

SCALE 1/500.000 ANGLE 10.000

* * 座 標 L I S T * * (現 場 N O . 1)

測 点 名	X 座 標	Y 座 標
3-1	-60968.684	-87714.034
3-2	-60960.683	-87740.256
3-3	-60958.539	-87747.306
3-7	-60954.605	-87760.172
3-9	-60947.520	-87783.511
3-10	-60935.603	-87822.563
3-11	-60931.682	-87835.420
3-12	-60928.531	-87845.678
3-13	-60938.699	-87848.773
3-14	-60938.959	-87848.938
3-15	-60947.949	-87854.708
3-16	-60951.901	-87853.276
3-17	-60955.165	-87842.579
3-18	-60959.069	-87829.708
3-19	-60970.974	-87790.652
3-21	-60978.070	-87767.311
3-25	-60981.995	-87754.430
3-26	-60984.149	-87747.385
3-27	-60992.139	-87721.182
3-28	-60942.092	-87838.593
3-29	-60976.858	-87771.297
3-30	-60953.396	-87764.153
3-31	-60957.664	-87750.166
3-32	-60981.120	-87757.302
3-33	-60957.305	-87751.343
3-34	-60980.761	-87758.480
3-35	-60957.034	-87752.228
3-36	-60980.491	-87759.365

* * 面積計算 (座標法) * *

地番 器械点	3-1 視準点	内角	方向角	距離	[1] X(i)	[2] Y(i)	[3] X(i+1)-X(i-1)	[2]*[3]
3-14	3-15	105-50-44	212-41-36	10.682	-60938.959	-87848.938	-5.857	514531.229866
3-15	3-16	127-23-20	160-04-56	4.203	-60947.949	-87854.708	-12.942	1137015.630936
3-16	3-17	126-53-11	106-58-07	11.184	-60951.901	-87853.276	-7.216	633949.239616
3-17	3-28	89-59-09	16-57-16	13.667	-60955.165	-87842.579	9.809	-861647.857411
3-28	3-14	89-53-36	286-50-52	10.808	-60942.092	-87838.593	16.206	-1423512.238158
							倍面積	336.004849
							面積	168.0024245
							(坪数)	(50.820)

* * 面積計算 (座標法) * *

地番 器械点	3-2 視準点	内角	方向角	距離	[1] X(i)	[2] Y(i)	[3] X(i+1)-X(i-1)	[2]*[3]
3-11	3-12	90-07-16	287-04-32	10.731	-60931.682	-87835.420	13.561	-1191136.130620
3-12	3-13	89-51-14	196-55-46	10.629	-60928.531	-87845.678	-7.017	616413.122526
3-13	3-14	195-28-13	212-23-59	0.308	-60938.699	-87848.773	-10.428	916087.004844
3-14	3-28	74-26-53	106-50-52	10.808	-60938.959	-87848.938	-3.393	298071.446634
3-28	3-11	90-06-24	16-57-16	10.883	-60942.092	-87838.593	7.277	-639201.441261
							倍面積	234.002123
							面積	117.0010615
							(坪数)	(35.392)

* * 面積計算 (座標法) * *

地番 器械点	3-3 視準点	内角	方向角	距離	[1] X(i)	[2] Y(i)	[3] X(i+1)-X(i-1)	[2]*[3]
3-11	3-28	89-59-40	196-57-16	10.883	-60931.682	-87835.420	-6.489	569964.040380
3-28	3-17	180-00-00	196-57-16	13.667	-60942.092	-87838.593	-23.483	2062713.679419
3-17	3-18	89-55-08	106-52-24	13.450	-60955.165	-87842.579	-16.977	1491303.463683
3-18	3-10	90-03-41	16-56-05	24.530	-60959.069	-87829.708	19.562	-1718124.747896
3-10	3-11	90-01-31	286-57-36	13.442	-60935.603	-87822.563	27.387	-2405196.532881
							倍面積	659.902705
							面積	329.9513525
							(坪数)	(99.810)

* * 面積計算 (座標法) * *

地番 器械点	3-5-1 視準点	内角	方向角	距離	[1] X(i)	[2] Y(i)	[3] X(i+1)-X(i-1)	[2]*[3]
3-35	3-7	90-04-48	287-00-07	8.307	-60957.034	-87752.228	25.886	-2271554.174008
3-7	3-21	89-55-12	196-55-19	24.527	-60954.605	-87760.172	-21.036	1846122.978192
3-21	3-36	90-01-29	106-56-48	8.307	-60978.070	-87767.311	-25.886	2271944.612546
3-36	3-35	89-58-31	16-55-19	24.519	-60980.491	-87759.365	21.036	-1846106.002140
							倍面積	407.414590
							面積	203.7072950
							(坪数)	(61.621)

* * 面積計算 (座標法) * *

地番 : 3-5-2
器械点 視準点

	内角	方向角	距離	[1] X(i)	[2] Y(i)	[3] X(i+1)-X(i-1)	[2]*[3]
3-33	90-04-48	287-00-07	0.925	-60957.305	-87751.343	23.727	-2082076.115361
3-35	89-55-12	196-55-19	24.519	-60957.034	-87752.228	-23.186	2034623.158408
3-36	90-01-29	106-56-48	0.925	-60980.491	-87759.365	-23.727	2082266.453355
3-34	89-58-31	16-55-19	24.518	-60980.761	-87758.480	23.186	-2034768.117280
						倍面積	45.379122
						面積	22.6895610
						(坪數)	(6.863)

* * 面積計算 (座標法) * *

地番 : 3-5-3
器械点 視準点

	内角	方向角	距離	[1] X(i)	[2] Y(i)	[3] X(i+1)-X(i-1)	[2]*[3]
3-31	90-04-48	287-00-07	1.231	-60957.664	-87750.166	23.815	-2089770.203290
3-33	89-55-12	196-55-19	24.518	-60957.305	-87751.343	-23.097	2026792.769271
3-34	90-01-29	106-56-48	1.231	-60980.761	-87758.480	-23.815	2089968.201200
3-32	89-58-31	16-55-19	24.517	-60981.120	-87757.302	23.097	-2026930.404294
						倍面積	60.362887
						面積	30.1814435
						(坪數)	(9.129)

* * 面積計算 (座標法) * *

地番 : 3-5-4
器械点 視準点

	内角	方向角	距離	[1] X(i)	[2] Y(i)	[3] X(i+1)-X(i-1)	[2]*[3]
3-25	89-56-52	16-53-40	24.514	-60981.995	-87754.430	22.581	-1981582.783830
3-3	90-06-27	287-00-07	2.991	-60958.539	-87747.306	24.331	-2134979.702286
3-31	89-55-12	196-55-19	24.517	-60957.664	-87750.166	-22.581	1981486.498446
3-32	90-01-29	106-56-48	3.008	-60981.120	-87757.302	-24.331	2135222.914962
						倍面積	146.927292
						面積	73.4636460
						(坪數)	(22.222)

* * 面積計算 (座標法) * *

地番 : 3-7
器械点 視準点

	内角	方向角	距離	[1] X(i)	[2] Y(i)	[3] X(i+1)-X(i-1)	[2]*[3]
3-9	90-02-10	286-58-12	40.830	-60947.520	-87783.511	35.371	-3104990.567581
3-10	89-57-53	196-56-05	24.530	-60985.603	-87822.563	-11.549	1014262.780087
3-18	90-01-03	106-57-08	40.830	-60959.069	-87829.708	-35.371	3106624.601668
3-19	89-58-54	16-56-02	24.517	-60970.974	-87790.652	11.549	-1013894.239948
						倍面積	2002.574226
						面積	1001.2871130
						(坪數)	(302.889)

* * 面積計算 (座標法) * *

地番 : 3-8-1
器械点 視準点

	内角	方向角	距離	[1] X(i)	[2] Y(i)	[3] X(i+1)-X(i-1)	[2]*[3]
3-29	89-58-34	106-54-36	4.166	-60976.858	-87771.297	-24.674	2165668.982178
3-21	90-00-43	16-55-19	24.527	-60978.070	-87767.311	22.253	-1953085.971683
3-7	89-57-53	286-53-12	4.161	-60954.605	-87760.172	24.674	-2165394.483928
3-30	90-02-50	196-56-02	24.525	-60953.396	-87764.153	-22.253	1953015.696709
						倍面積	204.223276
						面積	102.1116380
						(坪數)	(30.888)

* * 面積計算 (座標法) * *

地番 : 3-8-2
器械点 視準点

	内角	方向角	距離	[1] X(i)	[2] Y(i)	[3] X(i+1)-X(i-1)	[2]*[3]
3-9	90-02-50	196-56-02	24.517	-60947.520	-87783.511	-17.578	1543058.556358
3-19	89-58-34	106-54-36	20.230	-60970.974	-87790.652	-29.338	2575602.148376
3-29	90-01-26	16-56-02	24.525	-60976.858	-87771.297	17.578	-1542843.858666
3-30	89-57-10	286-53-12	20.230	-60953.396	-87764.153	29.338	-2574824.720714
						倍面積	992.125354
						面積	496.0626770
						(坪數)	(150.058)

* * 面積計算 (座標法) * *

地番 : 3-9
器械点 視準点

	内角	方向角	距離	[1] X(i)	[2] Y(i)	[3] X(i+1)-X(i-1)	[2]*[3]
3-2	90-00-59	286-54-55	7.369	-60960.683	-87740.256	25.610	-2247027.956160
3-3	89-58-45	196-53-40	24.514	-60958.539	-87747.306	-21.312	1870070.585472
3-25	90-06-23	107-00-03	7.367	-60981.995	-87754.430	-25.610	2247390.952300
3-26	89-53-53	16-53-56	24.525	-60984.149	-87747.385	21.312	-1870072.269120
						倍面積	361.312492
						面積	180.6562460
						(坪數)	(54.648)

* * 面積計算 (座標法) * *

地番 : 3-10
器械点 視準点

	内角	方向角	距離	[1] X(i)	[2] Y(i)	[3] X(i+1)-X(i-1)	[2]*[3]
3-1	90-01-10	286-58-06	27.415	-60968.684	-87714.034	31.456	-2759132.653504
3-2	89-55-50	196-53-56	24.525	-60960.683	-87740.256	-15.465	1356903.059040
3-26	90-03-32	106-57-28	27.394	-60984.149	-87747.385	-31.456	2760181.742560
3-27	89-59-28	16-56-56	24.520	-60992.139	-87721.182	15.465	-1356608.079630
						倍面積	1344.068466
						面積	672.0342330
						(坪數)	(203.290)

B - 4

B - 4

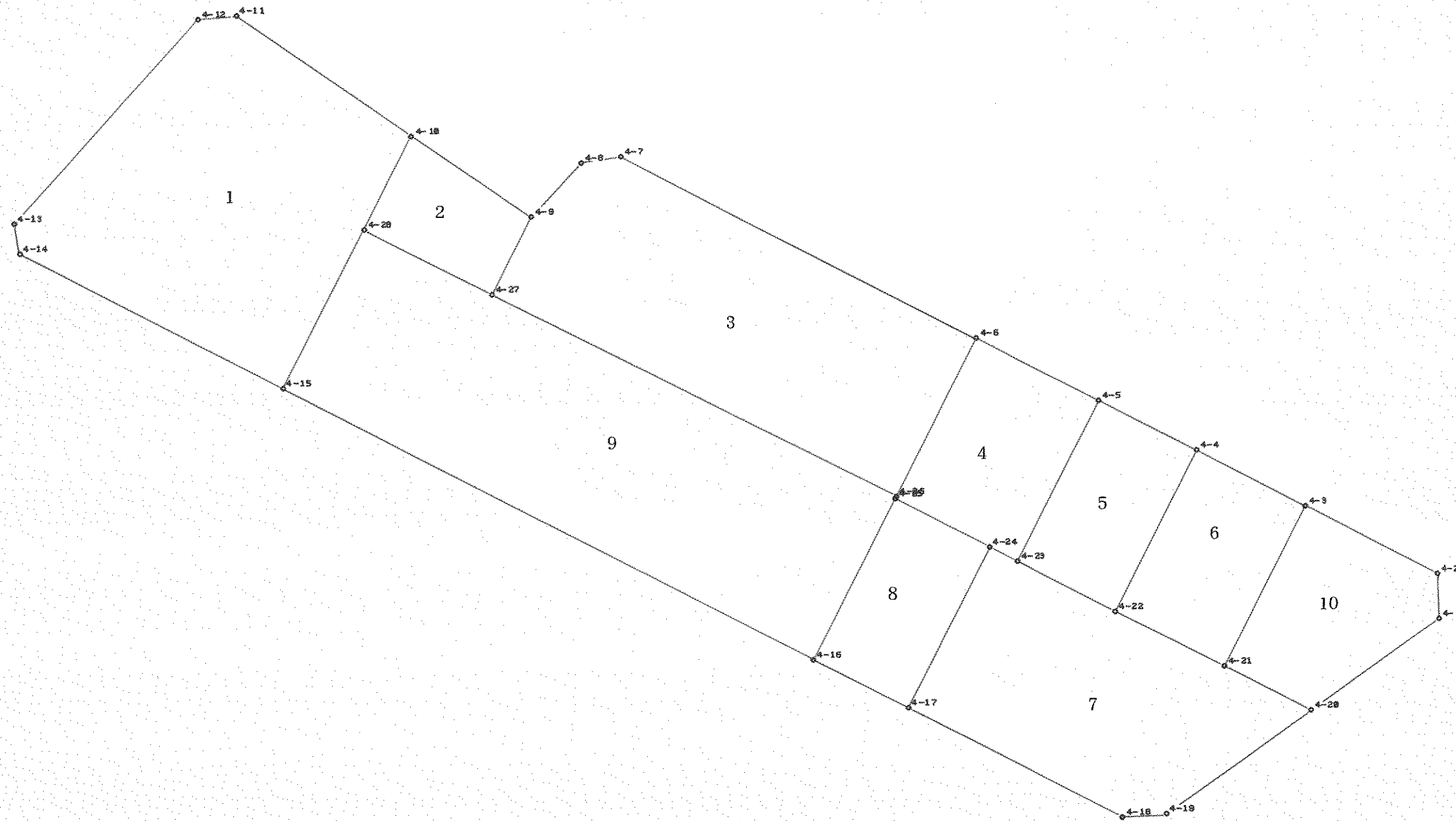

* * 座 標 L I S T * * (現 場 N O . 1)

測点名	X 座 標	Y 座 標
4-1	-61000.285	-87733.853
4-2	-60994.170	-87735.100
4-3	-60988.143	-87754.891
4-4	-60983.242	-87770.987
4-5	-60978.828	-87785.479
4-6	-60973.271	-87803.730
4-7	-60957.167	-87856.612
4-8	-60959.103	-87861.877
4-9	-60967.700	-87867.388
4-10	-60959.439	-87885.655
4-11	-60947.285	-87912.545
4-12	-60948.885	-87917.592
4-13	-60981.207	-87937.748
4-14	-60985.196	-87936.252
4-15	-60997.106	-87897.119
4-16	-61021.098	-87818.285
4-17	-61025.364	-87804.268
4-18	-61035.066	-87772.389
4-19	-61033.589	-87766.587
4-20	-61015.952	-87749.251
4-21	-61012.021	-87762.167
4-22	-61007.124	-87778.256
4-23	-61002.714	-87792.749
4-24	-61001.425	-87796.983
4-25	-60997.159	-87811.000
4-26	-60996.845	-87810.904
4-27	-60979.148	-87870.875
4-28	-60973.360	-87889.892

* * 面積計算 (座標法) * *

地番 器械点	4-1 視準点	内角	方向角	距離	[1] X(i)	[2] Y(i)	[3] X(i+1)-X(i-1)	[2]*[3]
4-10	4-11	97-23-44	294-19-21	29.509	-60959.439	-87885.655	26.075	-2291618.454125
4-11	4-12	138-05-16	252-24-37	5.295	-60947.285	-87912.545	10.554	-927828.999930
4-12	4-13	139-32-15	211-56-52	38.092	-60948.885	-87917.592	-33.922	2982340.555824
4-13	4-14	127-29-41	159-26-33	4.260	-60981.207	-87937.748	-36.311	3193107.567628
4-14	4-15	127-29-04	106-55-37	40.906	-60985.196	-87936.252	-15.899	1398098.470548
4-15	4-28	90-00-00	16-55-37	24.821	-60997.106	-87897.119	11.836	-1040350.300484
4-28	4-10	180-00-00	16-55-37	14.552	-60973.360	-87889.892	37.667	-3310548.561964
							倍面積	3200.277497
							面積	1600.1387485
							(坪數)	(484.041)

* * 面積計算 (座標法) * *

地番 器械点	4-2 視準点	内角	方向角	距離	[1] X(i)	[2] Y(i)	[3] X(i+1)-X(i-1)	[2]*[3]
4-27	4-9	90-00-42	16-56-19	11.967	-60979.148	-87870.875	5.660	-497349.152500
4-9	4-10	97-23-44	294-20-03	20.048	-60967.700	-87867.388	19.709	-1731778.350092
4-10	4-28	82-35-34	196-55-37	14.552	-60959.439	-87885.655	-5.660	497432.807300
4-28	4-27	90-00-00	106-55-37	19.879	-60973.360	-87889.892	-19.709	1732221.881428
							倍面積	527.186136
							面積	263.5930680
							(坪數)	(79.736)

* * 面積計算 (座標法) * *

地番 器械点	4-3 視準点	内角	方向角	距離	[1] X(i)	[2] Y(i)	[3] X(i+1)-X(i-1)	[2]*[3]
4-6	4-7	90-00-35	286-56-12	55.280	-60973.271	-87803.730	39.678	-3483876.398940
4-7	4-8	142-52-27	249-48-39	5.610	-60957.167	-87856.612	14.168	-1244752.478816
4-8	4-9	142-51-02	212-39-41	10.212	-60959.103	-87861.877	-10.533	925449.150441
4-9	4-27	164-16-38	196-56-19	11.967	-60967.700	-87867.388	-20.045	1761301.792460
4-27	4-26	89-30-10	106-26-29	62.527	-60979.148	-87870.875	-29.145	2560996.651875
4-26	4-6	90-29-08	16-55-37	24.642	-60996.845	-87810.904	5.877	-516064.682808
							倍面積	3054.034212
							面積	1527.0171060
							(坪數)	(461.922)

* * 面積計算 (座標法) * *

地番 器械点	4-4 視準点	内角	方向角	距離	[1] X(i)	[2] Y(i)	[3] X(i+1)-X(i-1)	[2]*[3]
4-5	4-6	90-00-26	286-56-06	19.078	-60978.828	-87785.479	29.443	-2584667.858197
4-6	4-26	89-59-31	196-55-37	24.642	-60973.271	-87803.730	-18.017	1581959.803410
4-26	4-25	180-00-00	196-55-37	0.328	-60996.845	-87810.904	-23.888	2097626.874752
4-25	4-24	90-00-00	106-55-37	14.652	-60997.159	-87811.000	-4.580	402174.380000
4-24	4-23	180-00-00	106-55-37	4.426	-61001.425	-87796.983	-5.555	487712.240565
4-23	4-5	90-00-03	16-55-40	24.967	-61002.714	-87792.749	22.597	-1983852.749153
							倍面積	952.691377
							面積	476.3456885
							(坪數)	(144.094)

* * 面積計算 (座標法) * *

地番 器械点	視準点	内角	方向角	距離	[1] X(i)	[2] Y(i)	[3] X(i+1)-X(i-1)	[2]*[3]
4-4	4-5	90-00-42	286-56-19	15.149	-60983.242	-87770.987	28.296	-2483567.848152
4-5	4-23	89-59-21	196-55-40	24.967	-60978.828	-87785.479	-19.472	1709358.847088
4-23	4-22	89-59-57	106-55-37	15.149	-61002.714	-87792.749	-28.296	2484183.625704
4-22	4-4	90-00-00	16-55-37	24.964	-61007.124	-87778.256	19.472	-1709218.200832
							倍面積	756.423808
							面積	378.2119040
							(坪數)	(114.409)

* * 面積計算 (座標法) * *

地番 器械点	視準点	内角	方向角	距離	[1] X(i)	[2] Y(i)	[3] X(i+1)-X(i-1)	[2]*[3]
4-4	4-22	89-59-25	196-55-37	24.964	-60983.242	-87770.987	-18.981	1665981.104247
4-22	4-21	90-00-00	106-55-37	16.817	-61007.124	-87778.256	-28.779	2526170.429424
4-21	4-3	90-01-11	16-56-48	24.962	-61012.021	-87762.167	18.981	-1665813.691827
4-3	4-4	89-59-24	286-56-12	16.826	-60988.143	-87754.891	28.779	-2525498.008089
							倍面積	839.833755
							面積	419.9168775
							(坪數)	(127.024)

* * 面積計算 (座標法) * *

地番 器械点	視準点	内角	方向角	距離	[1] X(i)	[2] Y(i)	[3] X(i+1)-X(i-1)	[2]*[3]
4-18	4-19	148-47-27	75-43-04	5.987	-61035.066	-87772.389	-8.225	721927.899525
4-19	4-20	148-47-16	44-30-20	24.731	-61033.589	-87766.587	19.114	-1677570.543918
4-20	4-21	62-25-17	286-55-37	13.500	-61015.952	-87749.251	21.568	-1892575.845568
4-21	4-22	180-00-00	286-55-37	16.817	-61012.021	-87762.167	8.828	-774764.410276
4-22	4-23	180-00-00	286-55-37	15.149	-61007.124	-87778.256	9.307	-816952.228592
4-23	4-24	180-00-00	286-55-37	4.426	-61002.714	-87792.749	5.699	-500330.876551
4-24	4-17	90-00-00	196-55-37	25.023	-61001.425	-87796.983	-22.650	1988601.664950
4-17	4-18	90-00-00	106-55-37	33.323	-61025.364	-87804.268	-33.641	2953823.379788
							倍面積	2159.039358
							面積	1079.5196790
							(坪數)	(326.554)

* * 面積計算 (座標法) * *

地番 器械点	視準点	内角	方向角	距離	[1] X(i)	[2] Y(i)	[3] X(i+1)-X(i-1)	[2]*[3]
4-24	4-25	90-00-00	286-55-37	14.652	-61001.425	-87796.983	28.205	-2476313.905515
4-25	4-16	90-00-00	196-55-37	25.023	-60997.159	-87811.000	-19.673	1727505.803000
4-16	4-17	90-00-00	106-55-37	14.652	-61021.098	-87818.285	-28.205	2476914.728425
4-17	4-24	90-00-00	16-55-37	25.023	-61025.364	-87804.268	19.673	-1727373.364364
							倍面積	733.261546
							面積	366.6307730
							(坪數)	(110.905)

* * 面積計算 (座標法) * *

地番 器械点	4-9 視準点	内角	方向角	距離	[1] X(i)	[2] Y(i)	[3] X(i+1)-X(i-1)	[2]*[3]
4-27	4-28	180-29-08	286-55-37	19.879	-60979.148	-87870.875	23.485	-2063647.499375
4-28	4-15	90-00-00	196-55-37	24.821	-60973.360	-87889.892	-17.958	1578326.680536
4-15	4-16	90-00-00	106-55-37	82.403	-60997.106	-87897.119	-47.738	4196032.666822
4-16	4-25	90-00-00	16-55-37	25.023	-61021.098	-87818.285	-0.053	4654.369105
4-25	4-26	180-00-00	16-55-37	0.328	-60997.159	-87811.000	24.253	-2129680.183000
4-26	4-27	89-30-52	286-26-29	62.527	-60996.845	-87810.904	18.011	-1581562.191944
							倍面積	4123.842144
							面積	2061.9210720
							(坪数)	(623.731)

* * 面積計算 (座標法) * *

地番 器械点	4-10 視準点	内角	方向角	距離	[1] X(i)	[2] Y(i)	[3] X(i+1)-X(i-1)	[2]*[3]
4-21	4-20	89-58-49	106-55-37	13.500	-61012.021	-87762.167	-27.809	2440578.102103
4-20	4-1	117-34-43	44-30-20	21.967	-61015.952	-87749.251	11.736	-1029825.209736
4-1	4-2	123-58-06	348-28-26	6.241	-61000.285	-87733.853	21.782	-1911018.786046
4-2	4-3	118-27-46	286-56-12	20.688	-60994.170	-87735.100	12.142	-1065279.584200
4-3	4-21	90-00-36	196-56-48	24.962	-60988.143	-87754.891	-17.851	1566512.559241
							倍面積	967.081362
							面積	483.5406810
							(坪数)	(146.271)

B - 5

B - 5

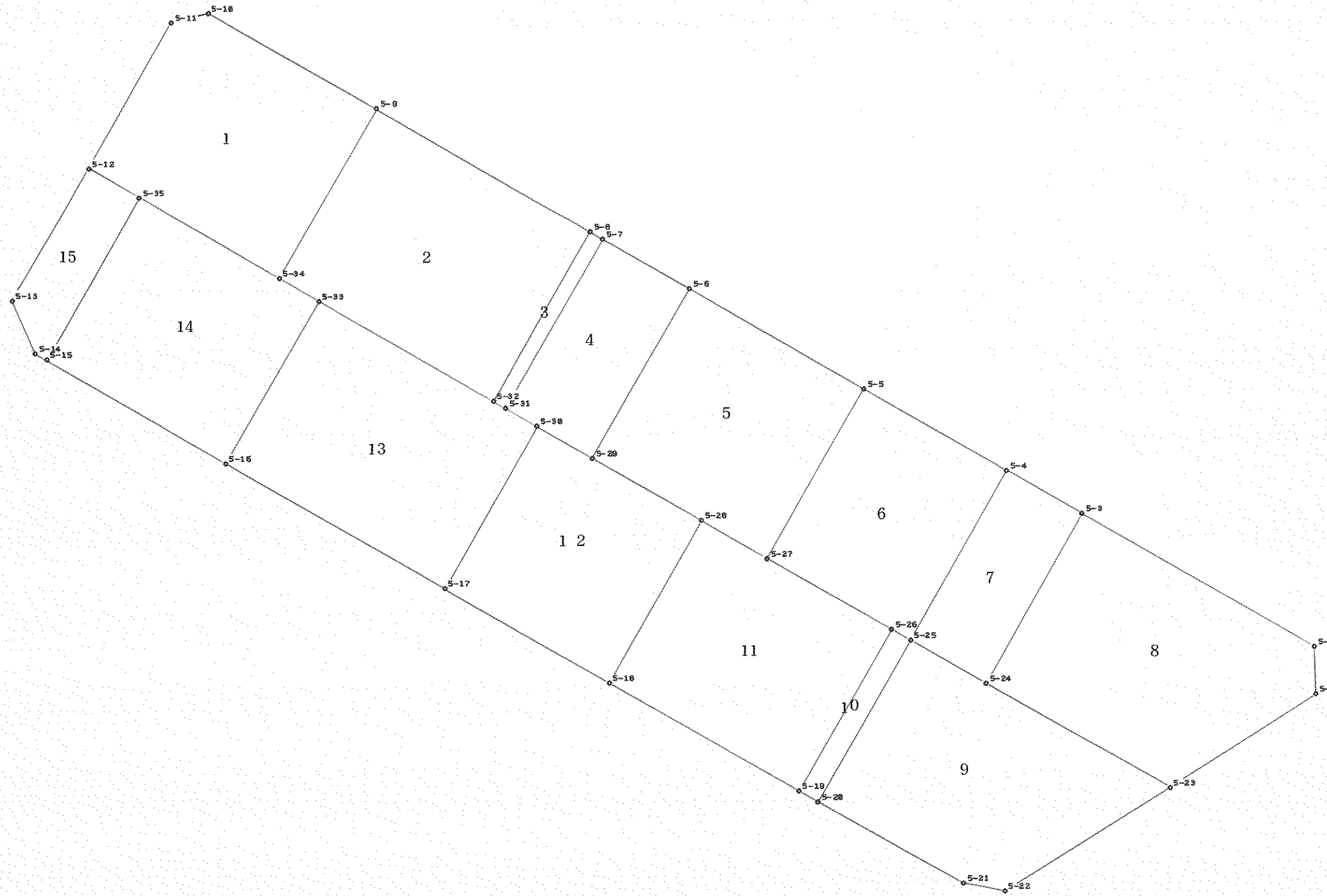

SCALE 1/600,000 ANGLE 12.500

* * 座 標 L I S T * * (現 場 N O . 1)

測 点 名	X 座 標	Y 座 標
5-1	-61045.192	-87777.992
5-2	-61039.166	-87779.526
5-3	-61028.989	-87812.965
5-4	-61025.677	-87823.846
5-5	-61019.413	-87844.427
5-6	-61011.734	-87869.661
5-7	-61007.945	-87882.109
5-8	-61007.413	-87883.856
5-9	-60998.020	-87914.721
5-10	-60990.640	-87938.969
5-11	-60992.969	-87943.337
5-12	-61014.078	-87949.768
5-13	-61033.138	-87955.574
5-14	-61039.229	-87951.047
5-15	-61039.691	-87949.527
5-16	-61047.568	-87923.630
5-17	-61057.148	-87892.129
5-18	-61064.334	-87868.504
5-19	-61072.667	-87841.104
5-20	-61073.496	-87838.381
5-21	-61079.845	-87817.505
5-22	-61079.750	-87811.967
5-23	-61061.459	-87793.985
5-24	-61053.426	-87820.397
5-25	-61050.116	-87831.279
5-26	-61049.290	-87833.994
5-27	-61043.856	-87851.861
5-28	-61040.957	-87861.394
5-29	-61036.181	-87877.096
5-30	-61033.771	-87885.019
5-31	-61032.395	-87889.545
5-32	-61031.863	-87891.292
5-33	-61024.191	-87916.519
5-34	-61022.476	-87922.159
5-35	-61016.314	-87942.417

* * 面積計算 (座標法) * *

地番 器械点	5-9 視準点	内角	方向角	距離	[1] X(i)	[2] Y(i)	[3] X(i+1)-X(i-1)	[2]*[3]
5-24	5-25	180-00-00	286-55-01	11.374	-61053.426	-87820.397	11.343	-996146.763171
5-25	5-20	89-58-45	196-53-46	24.435	-61050.116	-87831.279	-20.070	1762773.769530
5-20	5-21	90-01-15	106-55-01	21.820	-61073.496	-87838.381	-29.729	2611347.228749
5-21	5-22	162-06-01	89-01-02	5.539	-61079.845	-87817.505	-6.254	549210.676270
5-22	5-23	135-29-43	44-30-45	25.650	-61079.750	-87811.967	18.386	-1614510.825262
5-23	5-24	62-24-16	286-55-01	27.608	-61061.459	-87793.985	26.324	-2311088.861140
							倍面積	1585.224976
							面積	792.6124880
							(坪数)	(239.765)

* * 面積計算 (座標法) * *

地番 器械点	5-10 視準点	内角	方向角	距離	[1] X(i)	[2] Y(i)	[3] X(i+1)-X(i-1)	[2]*[3]
5-25	5-26	90-01-15	286-55-01	2.838	-61050.116	-87831.279	24.206	-2126043.939474
5-26	5-19	90-00-00	196-55-01	24.435	-61049.290	-87833.994	-22.551	1980744.398694
5-19	5-20	90-00-00	106-55-01	2.847	-61072.667	-87841.104	-24.206	2126281.763424
5-20	5-25	89-58-45	16-53-46	24.435	-61073.496	-87838.381	22.551	-1980843.329931
							倍面積	138.892713
							面積	69.4463565
							(坪数)	(21.007)

* * 面積計算 (座標法) * *

地番 器械点	5-11 視準点	内角	方向角	距離	[1] X(i)	[2] Y(i)	[3] X(i+1)-X(i-1)	[2]*[3]
5-26	5-27	90-00-00	286-55-01	18.675	-61049.290	-87833.994	28.811	-2530585.201134
5-27	5-28	180-00-00	286-55-01	9.964	-61043.856	-87851.861	8.333	-732069.557713
5-28	5-18	90-00-00	196-55-01	24.435	-61040.957	-87861.394	-20.478	1799225.626332
5-18	5-19	90-00-00	106-55-01	28.639	-61064.334	-87868.504	-31.710	2786310.261840
5-19	5-26	90-00-00	16-55-01	24.435	-61072.667	-87841.104	15.044	-1321481.568576
							倍面積	1399.560749
							面積	699.7803745
							(坪数)	(211.683)

* * 面積計算 (座標法) * *

地番 器械点	5-12 視準点	内角	方向角	距離	[1] X(i)	[2] Y(i)	[3] X(i+1)-X(i-1)	[2]*[3]
5-28	5-29	90-00-00	286-55-01	16.412	-61040.957	-87861.394	28.153	-2473561.825282
5-29	5-30	180-00-00	286-55-01	8.281	-61036.181	-87877.096	7.186	-631484.811856
5-30	5-17	90-00-00	196-55-01	24.435	-61033.771	-87885.019	-20.967	1842685.193373
5-17	5-18	90-00-00	106-55-01	24.693	-61057.148	-87892.129	-30.563	2686247.138627
5-18	5-28	90-00-00	16-55-01	24.435	-61064.334	-87868.504	16.191	-1422678.948264
							倍面積	1206.746598
							面積	603.3732990
							(坪数)	(182.520)

* * 面積計算 (座標法) * *

地番 器械点	視準点	内角	方向角	距離	[1] X(i)	[2] Y(i)	[3] X(i+1)-X(i-1)	[2]*[3]
5-30	5-31	90-00-00	286-55-01	4.731	-61033.771	-87885.019	24.753	-2175417.875307
5-31	5-32	180-00-00	286-55-01	1.826	-61032.395	-87889.545	1.908	-167693.251860
5-32	5-33	180-00-00	286-55-01	26.368	-61031.863	-87891.292	8.204	-721060.159568
5-33	5-16	90-00-00	196-55-01	24.435	-61024.191	-87916.519	-15.705	1380728.930895
5-16	5-17	90-00-00	106-55-01	32.925	-61047.568	-87923.630	-32.957	2897699.073910
5-17	5-30	90-00-00	16-55-01	24.435	-61057.148	-87892.129	13.797	-1212647.703813
							倍面積	1609.014257
							面積	804.5071285
							(坪数)	(243.363)

* * 面積計算 (座標法) * *

地番 器械点	視準点	内角	方向角	距離	[1] X(i)	[2] Y(i)	[3] X(i+1)-X(i-1)	[2]*[3]
5-33	5-34	90-00-00	286-55-01	5.894	-61024.191	-87916.519	25.092	-2206001.294748
5-34	5-35	180-00-00	286-55-01	21.175	-61022.476	-87922.159	7.877	-692562.846443
5-35	5-15	90-00-00	196-55-01	24.435	-61016.314	-87942.417	-17.215	1513928.708655
5-15	5-16	90-00-00	106-55-01	27.069	-61039.691	-87949.527	-31.254	2748774.516858
5-16	5-33	90-00-00	16-55-01	24.435	-61047.568	-87923.630	15.500	-1362816.265000
							倍面積	1322.819322
							面積	661.4096610
							(坪数)	(200.076)

* * 面積計算 (座標法) * *

地番 器械点	視準点	内角	方向角	距離	[1] X(i)	[2] Y(i)	[3] X(i+1)-X(i-1)	[2]*[3]
5-35	5-12	90-00-00	286-55-01	7.683	-61016.314	-87942.417	25.613	-2252469.126621
5-12	5-13	90-01-33	196-56-34	19.924	-61014.078	-87949.768	-16.824	1479666.896832
5-13	5-14	126-26-11	143-22-45	7.589	-61033.138	-87955.574	-25.151	2212170.641674
5-14	5-15	143-32-16	106-55-01	1.589	-61039.229	-87951.047	-6.553	576343.210991
5-15	5-35	90-00-00	16-55-01	24.435	-61039.691	-87949.527	22.915	-2015363.411205
							倍面積	348.211671
							面積	174.1058355
							(坪数)	(52.667)

B - 6

B - 6

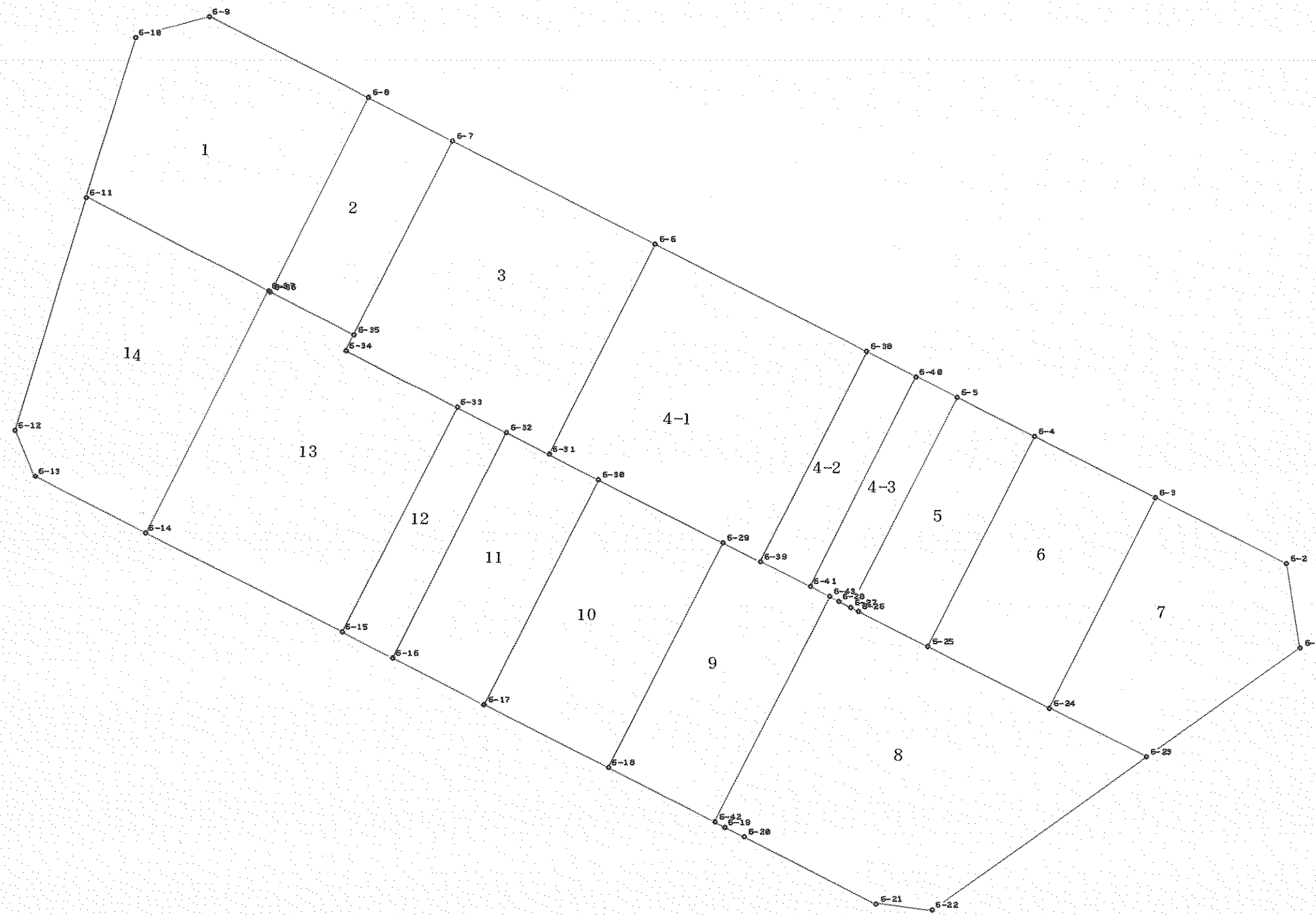

SCALE 1/500.000 ANGLE 10.000

* * 座 標 L I S T * * (現 場 N O . 1)

測 点 名	X 座 標	Y 座 標
6-1	-61094.209	-87826.253
6-2	-61085.695	-87829.204
6-3	-61081.165	-87844.105
6-4	-61076.972	-87857.884
6-5	-61074.319	-87866.656
6-6	-61063.838	-87901.093
6-7	-61056.792	-87924.237
6-8	-61053.877	-87933.797
6-9	-61048.313	-87952.048
6-10	-61051.902	-87959.395
6-11	-61069.557	-87961.559
6-12	-61095.216	-87964.703
6-13	-61099.726	-87961.743
6-14	-61103.552	-87949.179
6-15	-61110.370	-87926.790
6-16	-61112.120	-87921.043
6-17	-61115.292	-87910.625
6-18	-61119.615	-87896.429
6-19	-61123.644	-87883.244
6-20	-61124.334	-87880.974
6-21	-61128.947	-87865.899
6-22	-61128.515	-87859.990
6-23	-61108.504	-87840.348
6-24	-61105.133	-87851.422
6-25	-61100.932	-87865.203
6-26	-61098.520	-87873.122
6-27	-61098.258	-87873.969
6-28	-61097.829	-87875.394
6-29	-61093.814	-87888.558
6-30	-61089.488	-87902.751
6-31	-61087.766	-87908.402
6-32	-61086.288	-87913.256
6-33	-61084.560	-87918.931
6-34	-61080.719	-87931.547
6-35	-61078.894	-87930.989
6-36	-61075.973	-87940.554
6-37	-61075.908	-87940.766
6-38	-61071.168	-87877.008
6-39	-61095.114	-87884.296
6-40	-61072.878	-87871.390
6-41	-61096.827	-87878.678
6-42	-61123.325	-87884.289
6-43	-61097.521	-87876.402

* * 面積計算 (座標法) * *

地番 器械点	視準点	内角	方向角	距離	[1] X(i)	[2] Y(i)	[3] X(i+1)-X(i-1)	[2]*[3]
6-9	6-10	137-00-33	243-57-52	8.177	-61048.313	-87952.048	1.975	-173705.294800
6-10	6-11	123-01-20	186-59-12	17.787	-61051.902	-87959.395	-21.244	1868609.387380
6-11	6-37	99-59-53	106-59-05	21.740	-61069.557	-87961.559	-24.006	2111605.185354
6-37	6-36	180-00-00	106-59-05	0.222	-61075.908	-87940.766	-6.416	564227.954656
6-36	6-8	90-01-15	17-00-20	23.106	-61075.973	-87940.554	22.031	-1937418.345174
6-8	6-9	89-56-59	286-57-19	19.080	-61053.877	-87933.797	27.660	-2432248.825020
							倍面積	1070.062396
							面積	535.0311980
							(坪数)	(161.846)

* * 面積計算 (座標法) * *

地番 器械点	視準点	内角	方向角	距離	[1] X(i)	[2] Y(i)	[3] X(i+1)-X(i-1)	[2]*[3]
6-36	6-35	89-58-45	106-59-05	10.001	-61075.973	-87940.554	-25.017	2200008.839418
6-35	6-7	90-00-14	16-59-19	23.111	-61078.894	-87930.989	19.181	-1686604.300009
6-7	6-8	89-58-00	286-57-19	9.994	-61056.792	-87924.237	25.017	-2199600.637029
6-8	6-36	90-03-01	197-00-20	23.106	-61053.877	-87933.797	-19.181	1686658.160257
							倍面積	462.062637
							面積	231.0313185
							(坪数)	(69.886)

* * 面積計算 (座標法) * *

地番 器械点	視準点	内角	方向角	距離	[1] X(i)	[2] Y(i)	[3] X(i+1)-X(i-1)	[2]*[3]
6-6	6-7	89-56-48	286-55-57	24.193	-61063.838	-87901.093	30.974	-2722648.454582
6-7	6-35	90-03-22	196-59-19	23.111	-61056.792	-87924.237	-15.056	1323787.312272
6-35	6-34	180-00-00	196-59-19	1.908	-61078.894	-87930.989	-23.927	2103924.773803
6-34	6-33	89-56-43	106-56-02	13.188	-61080.719	-87931.547	-5.666	498220.145302
6-33	6-32	180-00-00	106-56-02	5.932	-61084.560	-87918.931	-5.569	489620.526739
6-32	6-31	180-00-00	106-56-02	5.074	-61086.288	-87913.256	-3.206	281849.898736
6-31	6-6	90-03-07	16-59-09	25.019	-61087.766	-87908.402	22.450	-1973543.624900
							倍面積	1210.577370
							面積	605.2886850
							(坪数)	(183.099)

* * 面積計算 (座標法) * *

地番 器械点	視準点	内角	方向角	距離	[1] X(i)	[2] Y(i)	[3] X(i+1)-X(i-1)	[2]*[3]
6-38	6-6	90-00-00	286-55-40	25.176	-61071.168	-87877.008	31.276	-2748441.302208
6-6	6-31	90-03-29	196-59-09	25.019	-61063.838	-87901.093	-16.598	1458982.341614
6-31	6-30	89-57-51	106-57-00	5.908	-61087.766	-87908.402	-25.650	2254850.511300
6-30	6-29	180-00-00	106-57-00	14.838	-61089.488	-87902.751	-6.048	531635.838048
6-29	6-39	180-00-42	106-57-42	4.456	-61093.814	-87888.558	-5.626	494461.027308
6-39	6-38	89-57-58	16-55-40	25.030	-61095.114	-87884.296	22.646	-1990227.767216
							倍面積	1260.648846
							面積	630.3244230
							(坪数)	(190.673)

* * 面積計算 (座標法) * *

地番 : 6-4-2
器械点 視準点

	内角	方向角	距離	[1] X(i)	[2] Y(i)	[3] X(i+1)-X(i-1)	[2]*[3]
6-40	90-00-00	286-55-40	5.873	-61072.878	-87871.390	25.659	-2254691.996010
6-38	90-00-00	196-55-40	25.030	-61071.168	-87877.008	-22.236	1954033.149888
6-39	90-02-02	106-57-42	5.873	-61095.114	-87884.296	-25.659	2255023.151064
6-41	89-57-58	16-55-40	25.034	-61096.827	-87878.678	22.236	-1954070.284008
						倍面積	294.020934
						面積	147.0104670
						(坪数)	(44.470)

* * 面積計算 (座標法) * *

地番 : 6-4-3
器械点 視準点

	内角	方向角	距離	[1] X(i)	[2] Y(i)	[3] X(i+1)-X(i-1)	[2]*[3]
6-43	180-00-00	106-57-42	1.054	-61097.521	-87876.402	-1.002	88052.154804
6-28	179-47-34	106-45-16	1.488	-61097.829	-87875.394	-0.737	64764.165378
6-27	90-13-58	16-59-14	25.031	-61098.258	-87873.969	23.510	-2065917.011190
6-5	89-56-26	286-55-40	4.948	-61074.319	-87866.656	25.380	-2230055.729280
6-40	90-00-00	196-55-40	25.034	-61072.878	-87871.390	-22.508	1977809.246120
6-41	90-02-02	106-57-42	2.380	-61096.827	-87878.678	-24.643	2165594.261954
						倍面積	247.087786
						面積	123.5438930
						(坪数)	(37.372)

* * 面積計算 (座標法) * *

地番 : 6-5
器械点 視準点

	内角	方向角	距離	[1] X(i)	[2] Y(i)	[3] X(i+1)-X(i-1)	[2]*[3]
6-4	89-50-29	286-49-39	9.164	-61076.972	-87857.884	26.613	-2338161.866892
6-5	90-09-35	196-59-14	25.031	-61074.319	-87866.656	-21.286	1870329.639616
6-27	90-12-04	107-11-18	0.887	-61098.258	-87873.969	-24.201	2126637.923769
6-26	179-45-06	106-56-24	8.278	-61098.520	-87873.122	-2.674	234972.728228
6-25	90-02-46	16-59-10	25.053	-61100.932	-87865.203	21.548	-1893319.394244
						倍面積	459.030477
						面積	229.5152385
						(坪数)	(69.428)

* * 面積計算 (座標法) * *

地番 : 6-6
器械点 視準点

	内角	方向角	距離	[1] X(i)	[2] Y(i)	[3] X(i+1)-X(i-1)	[2]*[3]
6-3	89-56-56	286-55-31	14.403	-61081.165	-87844.105	28.161	-2473777.840905
6-4	90-03-39	196-59-10	25.053	-61076.972	-87857.884	-19.767	1736686.793028
6-25	89-58-02	106-57-12	14.407	-61100.932	-87865.203	-28.161	2474371.981683
6-24	90-01-23	16-58-35	25.060	-61105.133	-87851.422	19.767	-1736559.058674
						倍面積	721.875132
						面積	360.9375660
						(坪数)	(109.183)

* * 面積計算 (座標法) * *

地番 : 6-7 器械点 視準点		内角	方向角	距離	[1] X(i)	[2] Y(i)	[3] X(i+1)-X(i-1)	[2]*[3]
6-1	6-2	116-17-13	340-53-00	9.011	-61094.209	-87826.253	22.809	-2003229.004677
6-2	6-3	126-01-35	286-54-35	15.574	-61085.695	-87829.204	13.044	-1145644.136976
6-3	6-24	90-04-00	196-58-35	25.060	-61081.165	-87844.105	-19.438	1707513.712990
6-24	6-23	89-57-15	106-55-50	11.576	-61105.133	-87851.422	-27.339	2401770.026058
6-23	6-1	117-39-57	44-35-47	20.075	-61108.504	-87840.348	10.924	-959567.961552
							倍面積	842.635843
							面積	421.3179215
							(坪數)	(127.448)

* * 面積計算 (座標法) * *

地番 : 6-8 器械点 視準点		内角	方向角	距離	[1] X(i)	[2] Y(i)	[3] X(i+1)-X(i-1)	[2]*[3]
6-42	6-19	89-59-43	106-59-31	1.093	-61123.325	-87884.289	-26.123	2295801.281547
6-19	6-20	179-54-56	106-54-27	2.373	-61123.644	-87883.244	-1.009	88674.193196
6-20	6-21	180-06-24	107-00-51	15.765	-61124.334	-87880.974	-5.303	466032.805122
6-21	6-22	158-48-16	85-49-07	5.925	-61128.947	-87865.899	-4.181	367367.323719
6-22	6-23	138-38-54	44-28-01	28.040	-61128.515	-87859.990	20.443	-1796121.775570
6-23	6-24	62-27-49	286-55-50	11.576	-61108.504	-87840.348	23.382	-2053883.016936
6-24	6-25	180-01-22	286-57-12	14.407	-61105.133	-87851.422	7.572	-665210.967384
6-25	6-26	179-59-12	286-56-24	8.278	-61100.932	-87865.203	6.613	-581052.587439
6-26	6-27	180-14-54	287-11-18	0.887	-61098.520	-87873.122	2.674	-234972.728228
6-27	6-28	179-33-58	286-45-16	1.488	-61098.258	-87873.969	0.691	-60720.912579
6-28	6-43	180-12-26	286-57-42	1.054	-61097.829	-87875.394	0.737	-64764.165378
6-43	6-42	90-02-06	196-59-48	26.982	-61097.521	-87876.402	-25.496	2240496.745392
							倍面積	1646.195462
							面積	823.0977310
							(坪數)	(248.987)

* * 面積計算 (座標法) * *

地番 : 6-9 器械点 視準点		内角	方向角	距離	[1] X(i)	[2] Y(i)	[3] X(i+1)-X(i-1)	[2]*[3]
6-29	6-18	90-00-13	196-57-55	26.975	-61093.814	-87888.558	-24.501	2153357.559558
6-18	6-42	90-01-36	106-59-31	12.694	-61119.615	-87896.429	-29.511	2593911.516219
6-42	6-43	90-00-17	16-59-48	26.982	-61123.325	-87884.289	22.094	-1941715.481166
6-43	6-41	89-57-54	286-57-42	2.380	-61097.521	-87876.402	26.498	-2328548.900196
6-41	6-39	180-00-00	286-57-42	5.873	-61096.827	-87878.678	2.407	-211523.977946
6-39	6-29	180-00-00	286-57-42	4.456	-61095.114	-87884.296	3.013	-264795.383848
							倍面積	685.332621
							面積	342.6663105
							(坪數)	(103.656)

* * 面積計算 (座標法) * *

地番 器械点	視準点	内角	方向角	距離	[1] X(i)	[2] Y(i)	[3] X(i+1)-X(i-1)	[2]*[3]
6-17	6-18	89-58-04	106-56-10	14.839	-61115.292	-87910.625	-30.127	2648483.399375
6-18	6-29	90-01-45	16-57-55	26.975	-61119.615	-87896.429	21.478	-1887839.502062
6-29	6-30	89-59-05	286-57-00	14.838	-61093.814	-87888.558	30.127	-2647818.586866
6-30	6-17	90-01-06	196-58-06	26.978	-61089.488	-87902.751	-21.478	1887975.285978
							倍面積	800.598425
							面積	400.2982125
							(坪數)	(121.090)

* * 面積計算 (座標法) * *

地番 器械点	視準点	内角	方向角	距離	[1] X(i)	[2] Y(i)	[3] X(i+1)-X(i-1)	[2]*[3]
6-16	6-17	90-09-38	106-56-10	10.890	-61112.120	-87921.043	-29.004	2550061.931172
6-17	6-30	90-01-56	16-58-06	26.978	-61115.292	-87910.625	22.632	-1989593.265000
6-30	6-31	89-58-54	286-57-00	5.908	-61089.488	-87902.751	27.528	-2419611.124026
6-31	6-32	179-59-02	286-56-02	5.074	-61087.766	-87908.402	3.200	-281306.886400
6-32	6-16	89-50-30	196-46-32	26.980	-61086.288	-87913.256	-24.354	2141039.436624
							倍面積	590.092370
							面積	295.0461850
							(坪數)	(89.251)

* * 面積計算 (座標法) * *

地番 器械点	視準点	内角	方向角	距離	[1] X(i)	[2] Y(i)	[3] X(i+1)-X(i-1)	[2]*[3]
6-15	6-16	90-00-04	106-56-10	6.007	-61110.370	-87926.790	-27.560	2423262.332400
6-16	6-32	89-50-22	16-46-32	26.980	-61112.120	-87921.043	24.082	-2117314.557526
6-32	6-33	90-09-30	286-56-02	5.932	-61086.288	-87913.256	27.560	-2422889.335360
6-33	6-15	90-00-04	196-56-06	26.979	-61084.560	-87918.931	-24.082	2117263.696342
							倍面積	322.135856
							面積	161.0679280
							(坪數)	(48.723)

* * 面積計算 (座標法) * *

地番 器械点	視準点	内角	方向角	距離	[1] X(i)	[2] Y(i)	[3] X(i+1)-X(i-1)	[2]*[3]
6-15	6-33	89-59-56	16-56-06	26.979	-61110.370	-87926.790	18.992	-1669905.595680
6-33	6-34	89-59-56	286-56-02	13.188	-61084.560	-87918.931	29.651	-2606884.223081
6-34	6-35	270-03-17	16-59-19	1.908	-61080.719	-87931.547	5.666	-498220.145302
6-35	6-36	89-59-46	286-59-05	10.001	-61078.894	-87930.989	4.746	-417320.473794
6-36	6-37	180-00-00	286-59-05	0.222	-61075.973	-87940.554	2.986	-262590.494244
6-37	6-14	89-56-30	196-55-35	28.896	-61075.908	-87940.766	-27.579	2425318.385514
6-14	6-15	90-00-35	106-56-10	23.405	-61103.552	-87949.179	-34.462	3030904.606698
							倍面積	1302.060111
							面積	651.0300555
							(坪數)	(196.936)

* * 面積計算 (座標法) * *

地番 : 6-14
器械点 視準点

	内角	方向角	距離	[1] X (i)	[2] Y (i)	[3] X (i+1) - X (i-1)	[2] * [3]
6-37	90-03-30	286-59-05	21.740	-61075.908	-87940.766	33.995	-2989546.340170
6-11	80-00-07	186-59-12	25.851	-61069.557	-87961.559	-19.308	1698361.781172
6-12	139-44-08	146-43-20	5.395	-61095.216	-87964.703	-30.169	2653807.124807
6-13	140-12-50	106-56-10	13.133	-61099.726	-87961.743	-8.336	733249.089648
6-14	89-59-25	16-55-35	28.896	-61103.552	-87949.179	23.818	-2094773.545422
						倍面積	1098.110035
						面積	549.0550175
						(坪数)	(166.089)

B - 7